

Manual Food Slicer

Model : WFS35MGB3

Heavy duty manual food slicer featuring a 350mm diameter blade and incorporating the latest safety features allowing for fast hygienic clean up. Ideal for Supermarkets and Butchers throughout Australia.

FEATURES

- high capacity carriage for extra large cuts of meat
- stow-away product holder for slicing flexibility
- patented Poly-V belt drive with automatic tensioner - NO belt slippage
- extremely quiet and smooth drive system
- 3rd generation 350 mm blade, with low-friction cutting edge for precise low-force slicing
- salami holder: an additional adjustable "fence" to keep round products stable when slicing
- integral sharpener: safe, effective and always at hand to regularly sharpen the blade
- ample operator access for fast cleanup of food debris behind blade
- attractive highly polished aluminium alloy construction allows easy cleaning and better hygiene
- net weight 35 kg

OPTION

- teflon coated gauge plate, blade and blade cover



SAFETY FEATURES

Blade safety ring: the blade is completely shrouded by a metal safety guard.

Safety interlock: the carriage interlock does not allow tilting of the carriage unless the index knob is set to zero. This prevents the blade from being exposed whilst cleaning, thereby reducing risk of injury.

Power fail safe: if mains power fails and is resumed, the slicer will not start until the slicer "on" button is re-selected by the operator. There is no risk of the slicer starting inadvertently.

No blade removal required: a large gap between the blade and motor housing allows easy access behind the blade for cleaning. There is no need for an operator to remove the blade.

CE Approved: this means the highest standards of design and manufacture have been adhered to for optimal level of safety for the user.

SPECIFICATIONS

Model Number	Blade Diameter (mm)	Slice Thickness (mm)	Overall Dimensions (mm)
WFS35MGB3	350	0 - 25	610 (W) x 778 (D) x 656 (H)

Specifications may change without notice

FOOD EQUIPMENT

Manual Food Slicer

Model : WFS35MGB3

ADDITIONAL SPECIFICATIONS

PRODUCT CAPACITY (mm)

Maximum Product Diameter	260 Ø
Maximum Slice Thickness	25

DIMENSIONS (mm)

Blade Diameter	350
Footprint	450 (W) x 590 (D)
Working Area Required	610 (W) x 800 (D)

Motor	IP65 rated water resistant
Switches	IP69 rated water resistant

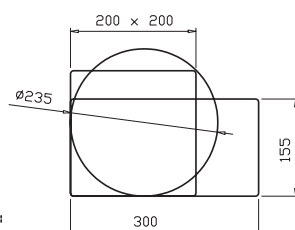
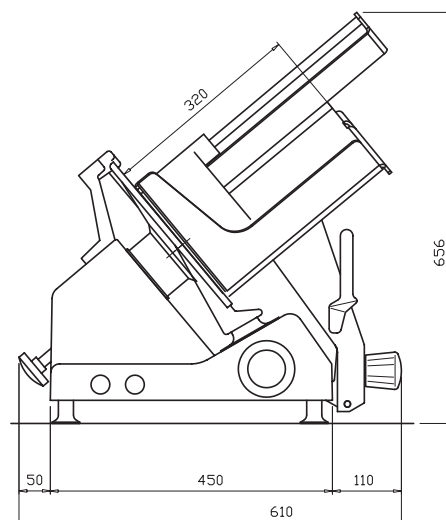
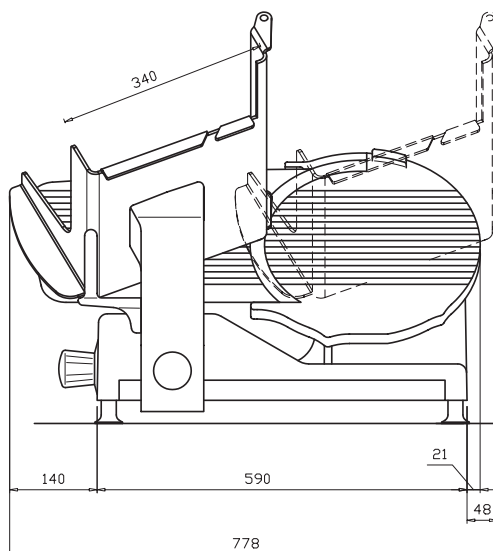

MAX. CUTTING SIZE:

MAX. CUTTING SETTING: 25 mm

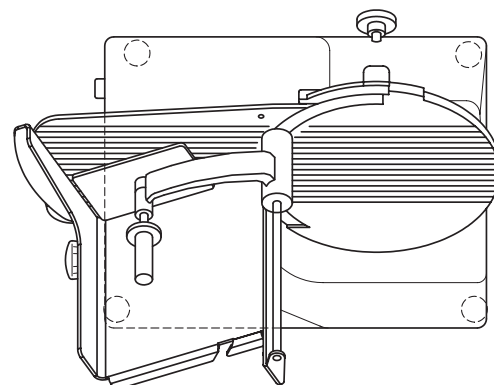

Specifications may change without notice

FOOD EQUIPMENT

LABELS | LABELLING EQUIPMENT | PACKAGING EQUIPMENT
ESL & DIGITAL SIGNAGE | WEIGHING SCALES | POS SYSTEMS
FOOD EQUIPMENT | MAINTENANCE & REPAIRS | HIRE

1300 970 111
enquiries@wedderburn.com.au
www.wedderburn.com.au